



Vodafone, London - Key meetings and briefings are hosted at this convenient London location. Designed by GMW Architects.



DuPont, Tamón Valley, Asturias, Spain - new office building.



Pier 6, Heathrow Airport. This new pier opened in January 2006 and will accommodate four Airbus A380s when they enter service.



Antalya International Airport The new Terminal 2 opened in April 2005. It serves Turkey's prime Mediterranean holiday destination.



Service centre, Ticketing and Shop Underground Station Berlin Alexanderplatz. Completion 2006.



European Parliament Building Extension, Brussels (in association). 77,000m² - office, conference, restaurant, broadcast & visitor facilities.



Residential Building in Metaxourgio - In this residential development in downtown Athens, all occupants enjoy multiple qualities of outdoor spaces.



Galeria Krakowska, Krakow 120,000m² development of part of the railway station area in the historic city centre providing retail, offices and parking.

The EAA – a European focus

The European Architects' Alliance is a consortium of architectural and design firms with 20+ offices across Europe. The Alliance is founded on the principle of mutually beneficial co-operation and its 650+ staff bring to projects the benefits of international experience and local knowledge across a wide range of sectors.

Over the last year Alliance members have been collaborating on a variety of projects as part of our framework agreements with international clients. These companies are quick to appreciate the advantages to be gained from working with the Alliance and we currently have commissions for Disney, Discovery Channel, JPMorgan Chase and Vodafone, to name a few, for projects across Europe. We are also pleased to be involved with exciting projects in the newest accession states, Romania and Bulgaria.

By formalizing our relationship within the European Architects' Alliance, we offer a clearly defined and responsive service to clients for projects throughout Europe.

- Our priorities are:
- Understanding the client
 - Sharing knowledge
 - Continuous improvement
 - Best-value targets
 - Concurrent design
 - Non-adversarial contracts
 - Increased client confidence

The network of European Architects' Alliance offices extends from Copenhagen to Rome and Madrid to Istanbul. The EAA is ideally placed to provide architectural and design services for clients whose requirements transcend national boundaries and offers particular advantages to multi-national firms pursuing global roll-out development programs.



GMW Architects



The Sazan Building, Erbil, Iraq - will offer first-class, modern office space in the thriving economic hub of the Kurdistan region. It will address an exceptionally high demand from both international and domestic companies for premium office space in a city where there is practically no supply.



Shuvalan Centre, Baku This is the winning entry to a design competition for a retail-led mixed-use development in the capital of Azerbaijan. The project includes office accommodation for the First Lady, who plays an important political and charitable role in Azeri society.



Metropolis Malta GMW Architects are working with the local practice of Dr Edwin Mintoff on a new mixed-use development. It will provide more than 200 apartments, a day-care centre, leisure facilities including a gym, swimming pool and health spa, office suites and retail space including boutique and food outlets to create active street frontages.

GMW Mimarlık



New shopping and leisure centre, Ankara, Turkey The proposed building houses a supermarket at ground floor and a multiplex cinema with the associated food court and retail units at first floor. A large over-sailing canopy marks the main entrance to the complex.



New headquarters for Turkcell in Istanbul, Turkey The central atrium space within this proposed headquarters for the leading mobile telephone service provider in Turkey houses social and recreational activities and achieves strong visual links between the various corporate departments.



Departures Lounge, Terminal TB3, Cairo International Airport Construction work on this 190,000m² terminal is scheduled for completion in 2007. Designed to cater for Cairo's rapidly expanding airport traffic, the new terminal will handle 7 million international and 3 million domestic passengers annually.

Collignon Fischötter Architekten



"Creative Spaces Berlin" Mixed-Use Development with an innovative usage and branding concept. Residential, Office, Hotel, Entertainment and Shops. Competition winner 2006 (in cooperation with Meta Design).



Steindamm, Hamburg Study for a Multi-Use-Building, 2006.



Harbour City University, Hamburg International competition 2006. Selected participant in cooperation with Murray & Laoire Architects.

CERAU



3rd Generation Accommodation, Brussels A hospitality establishment with 217 beds including 37 apartments for elderly, but able people.

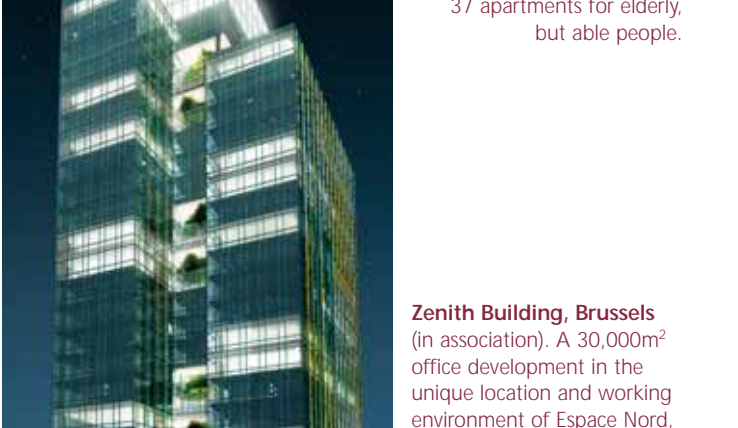

Zenith Building, Brussels (in association). A 30,000m² office development in the unique location and working environment of Espace Nord, one of the most important business districts in Brussels. The building, with its hanging gardens, is like an urban beacon and can be seen from many parts of the city.

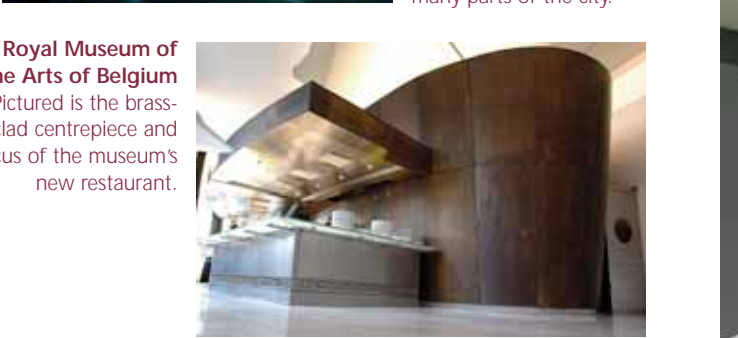

Royal Museum of Fine Arts of Belgium Pictured is the brass-clad centre-piece and focus of the museum's new restaurant.

klmf architects

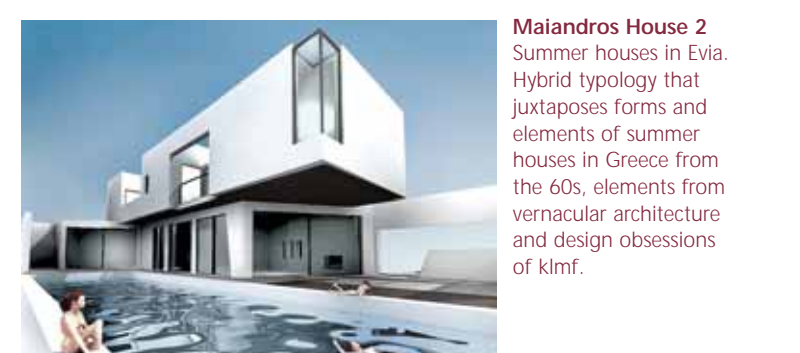

Maiandros House 2 Summer houses in Evia. Hybrid typology that juxtaposes forms and elements of summer houses in Greece from the 60s, elements from vernacular architecture and design obsessions of klmf.



Modern Art Gallery 'Elektrownia', Radom Adaptation and redevelopment of an old power station. Total area of 5,370 m². Competition winning project.



New Concert Hall and modernisation of Plac Wolności in Wrocław. Total area of 12,000 m². Competition Entry.

IMB Asymetria Architects



Residential development, Krakow 22,000 m² of high quality apartments in an old quarry, currently under construction.

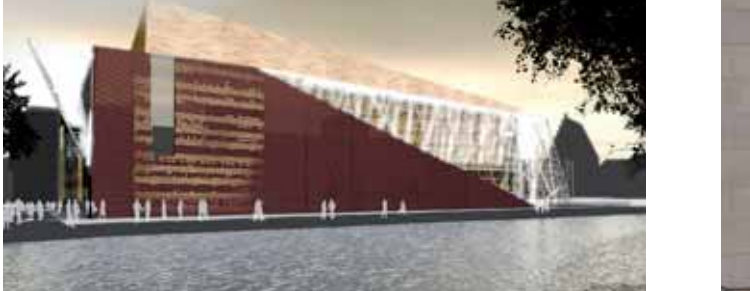

Emerging Landscapes in Karpenski A small conference centre, hotel for winter activities and recreational facility for summer camping. This building explores the possibilities between built space and nature.



125 Old Broad Street, London GMW Architects

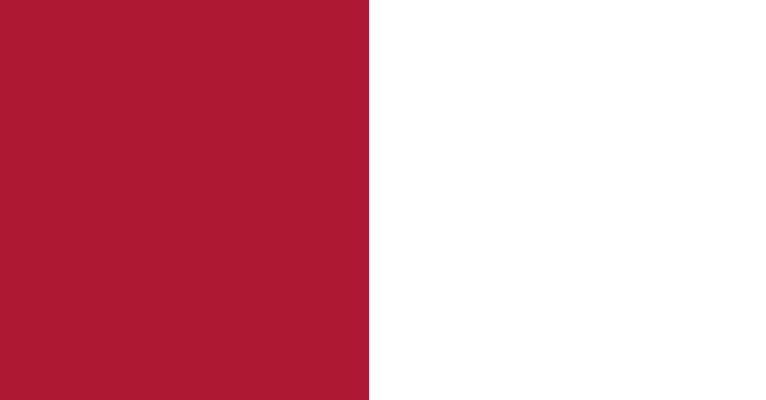

125 Old Broad Street, London GMW Architects

European Architects' Alliance

EAA members



Eurovea International Trade Centre, Bratislava Phase 2: a 183,000 sq.m. development comprising residential, office, retail, leisure, fitness and other amenities.



Office development for SNC Newton, Clamart. Aerial view of model.



LMG Site Masterplan 120,000m² located in South Harbour, Copenhagen. A collaboration with GMM Architects.



This project, one of the most recent of over 800 projects worldwide for Merrill Lynch, combines local materials, an updated palette and client brand.



Hotel Adriatic, Biograd Swimming pool completed in 2006.



Private residence, Madrid



Caldera Centre Environmentally conscious rehabilitation of an office complex in Milan, with extensive use of greenwalls and roofs and sun screens.

AMA Albera Monti & Associati **Milano, Roma, Genova & Palermo** Italy www.alberamonti-assoc.com
Tel: +39 02 8699 6670-6574 e-mail: n.monti@alberamonti.it
Contact: **Nicolas Monti**

CERAU s.p.r.l. **Brussels** Belgium www.cerau.com
Tel: +32 2 673 60 72 e-mail: bgerard@cerau.be
Contact: **Bruno Gerard**

Collignon Fischötter Architekten **Berlin** Germany.
www.cf-a.com Tel: +49 30 31 51 81-0 e-mail: mail@cf-a.com
Contact: **Oliver Collignon**

DesignGroup Architects **Copenhagen** Denmark www.dga.dk
Tel: +45 33 91 84 85 e-mail: info@dga.dk
Contacts: **Morten Jørgensen; Christian Giese**

FM Arquitectos **Madrid** Spain. www.fmarquitectos.com
Tel: +34 91 577 0664 e-mail: jgd@fmarquitectos.com
Contact: **James Drummond**

GMW Architects **London** UK www.gmw-architects.com
Tel: +44 20 7937 8020 e-mail: info@gmw-architects.com
Contact: **Lyn Edwards**

GMW Mimarlik ve Danismanlik Ltd **Istanbul** Turkey.
www.gmw.com.tr Tel: +90 212 327 1940
e-mail: gmw@gmw.com.tr Contact: **Ali Özveren**

IA Interior Architects **London** U.K. www.interiorarchitects.com
Tel: +44 20 7361 5622 e-mail: b.rutkowski@interiorarchitects.com
Contact: **Bill Rutkowski**

IMB Asymetria Architects **Kraków** Poland.
www.imbasymetria.pl Tel: +48 12 398 49 00
e-mail: biuro@imbasymetria.pl Contact: **Marek Borkowski**

Klmf architects **Athens** Greece. www.klmf.gr
Tel: +30 210 321 1139 e-mail: info@klmf.gr
Contact: **Konstantinos Labrinopoulos**

Murray Ó Laoire Architects **Dublin, Limerick & Cork** Ireland.
www.murrayolaoire.com Tel: +353 1 453 7300
e-mail: calbhac.ocarroll@murrayolaoire.com
Contact: **Calbhac O'Carroll**

Murray Ó Laoire Architects **Moscow** Russia.
www.murrayolaoire.com Tel: +7 495 937 3757 e-mail:
calbhac.ocarroll@murrayolaoire.com Contact: **Calbhac O'Carroll**

Murray Ó Laoire Architects **Bratislava** Slovakia.
www.murrayolaoire.com Tel: +421 2 5263 5344
e-mail: claran.ferrie@murrayolaoire.com Contact: **Ciaran Ferrie**

SERAU architectes et ingénieurs associés **Paris** France.
www.serau.com Tel: +331 4278 1233 e-mail: cremy@serau.com
Contact: **Christophe Rémy**

Tomislav Cop Architects **Zagreb** Croatia.
Tel: +385 98 1946 578 e-mail: tomislavcop@tomislavcop.com
Contact: **Tomislav Cop**

www.eaa-eu.com

Murray Ó Laoire Architects



Carton Hotel, Carton Demesne Co Kildare This project, completed May 2006, involved the conservation and conversion of Carton House into a '4-star plus' hotel. The scheme comprises 165 bedrooms, 147 of which are in a new-build hotel block, and 18 of which are in the original main house; bars and restaurants; a banqueting hall and a leisure centre and spa.



International Congress Centre, Rostov-On-Don The scheme accommodates a 23-storey four star hotel, an 800 seat congress hall, business centre, elite retail centre and incorporated underground and surface parking.

UL Thomond Student Village, Limerick Student accommodation sited on promontories created to preserve the natural flood plain and the seasonal nature of the landscape.

SERAU architectes et ingénieurs associés



Office development for SNC Newton, Clamart This new office development in the south-west of Paris is located in a fast-growing business and high-tech R&D area. The 45,000m² building can be divided into various units, each with a separate entrance if required. Air conditioning is provided throughout and there is parking for 1100 cars at basement level. The largely-glazed façades are designed in response to the magnificent landscape in which the building is set close to Avenue du Général de Gaulle.

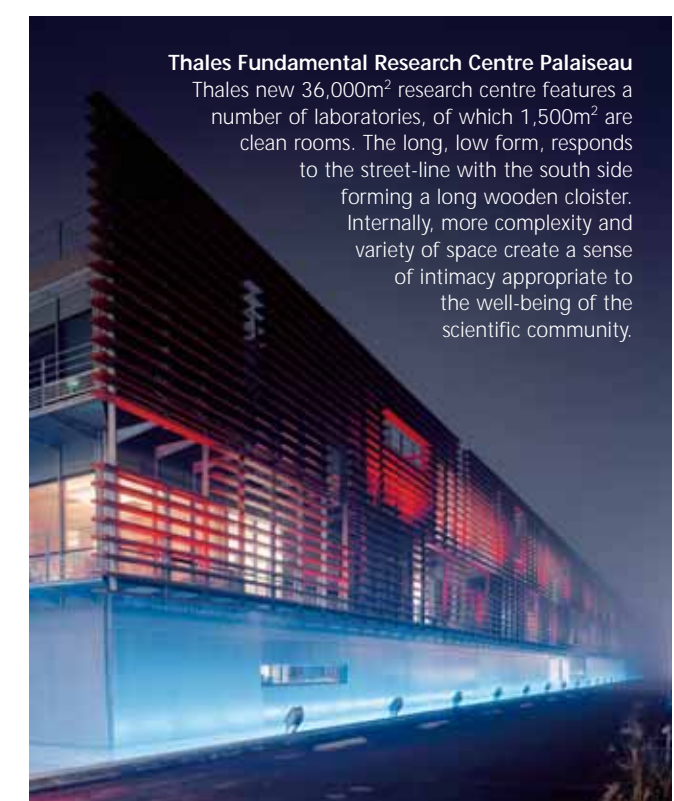

Thales Fundamental Research Centre Palaiseau Thales new 36,000m² research centre features a number of laboratories, of which 1,500m² are clean rooms. The long, low form, responds to the street-line with the south side forming a long wooden cloister. Internally, more complexity and variety of space create a sense of intimacy appropriate to the well-being of the scientific community.

DesignGroup Architects



Statoil, Copenhagen Apartments, a cinema and multi-storey car parking for Elsoe-Ejendomme. 10,000m² gross for completion in 2008.



Multi-storey car park, South Harbour, Copenhagen Completion in 2007 for Zeta Park. 15,000m² gross with space for 667 cars.

Tegholms Have, South Harbour, Copenhagen 142 full-ownership apartments for MT Højgaard. 12,600m² gross completed in 2006.



IA Interior Architects



Herman Miller, Shanghai IA's design articulates the Herman Miller brand for the region's clientele. Greeted at the door with a Chinese tea and tonic bar, visitors begin a tour featuring interaction with Herman Miller products. The project includes a showroom, training center and working office.

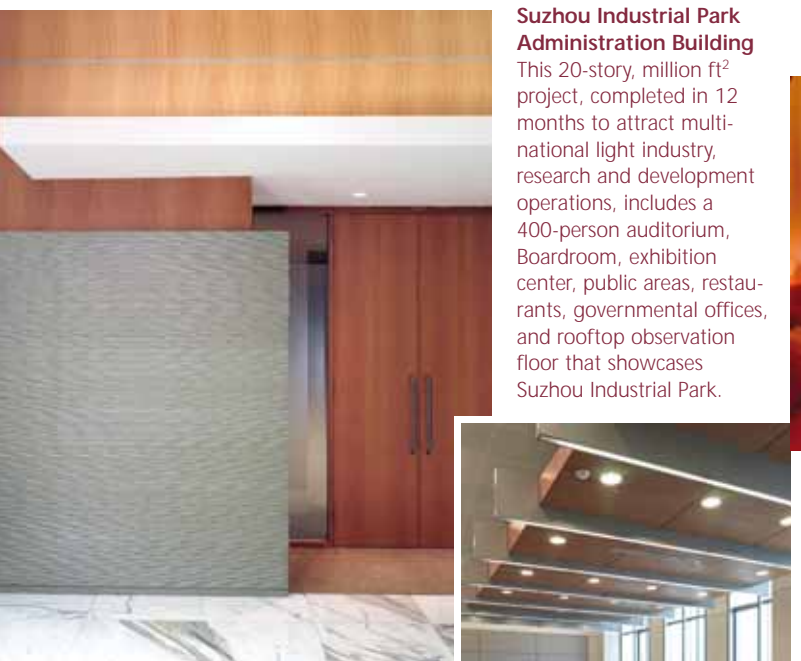

Suzhou Industrial Park Administration Building This 20-story, million ft² project, completed in 12 months to attract multi-national light industry, research and development operations, includes a 400-person auditorium, Boardroom, exhibition center, public areas, restaurants, governmental offices, and rooftop observation floor that showcases Suzhou Industrial Park.



Tomislav Cop Architects



Hotel Adriatic, Biograd This project involved the refurbishment of the hotel to 3 stars. The hotel comprises 105 guestrooms, a main restaurant, bar, outdoor bar and terrace together with a swimming pool. The inspiration for the hotel is lavender, the dominant native plant found on this part of the Croatian coast.

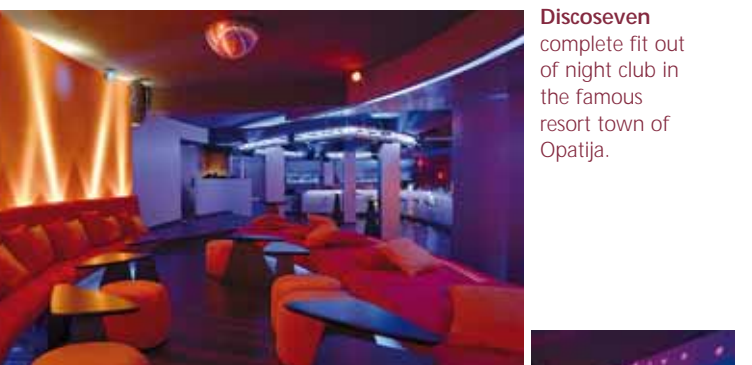

Discoveen complete fit out of night club in the famous resort town of Opatija.



FM Arquitectos



Polaris World, InterContinental Mar Menor Golf Resort, Murcia, Spain

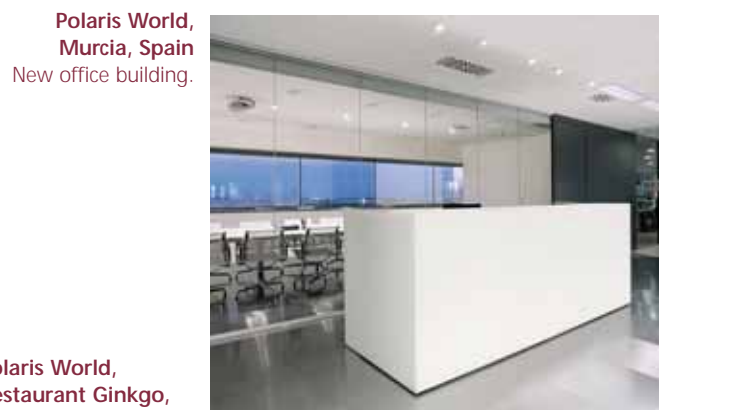

Polaris World, Restaurant Ginkgo, Murcia, Spain



AMA Albera Monti & Associati



Gruppo De Agostini, Rome. New office headquarters in a geometrically complex building of approximately 13,000 m².



Sant'Ambroeus Space for Travel Designing a travel agency is at the same time an architectural and communication project: part store, part office, a travel agency must be attractive, comfy and efficient.



In the heart of the winemaking Kakhetia region in the Georgian Caucasus, AMA designed an "hotel de charme" inside the walls of a ruined XV century castle. The new buildings reinterpret with a contemporary flair the traditional styles of Georgian architecture, bringing age-old local techniques and materials up-to-date.



Mercurio, god of commerce, hovers lightly above offices and stores. AMA designed for Fontana Arte a technical lamp with direct and indirect light and super-efficient yield.



Extension to the European Parliament (Under construction) Designed by CERAU in association

European Architects' Alliance